

Engine Block

Illustrated Index

 Lubricate all internal parts with engine oil during reassembly.

NOTE: Apply non-hardening liquid gasket to the mating surfaces of the right side cover and oil pump case, before installing them.

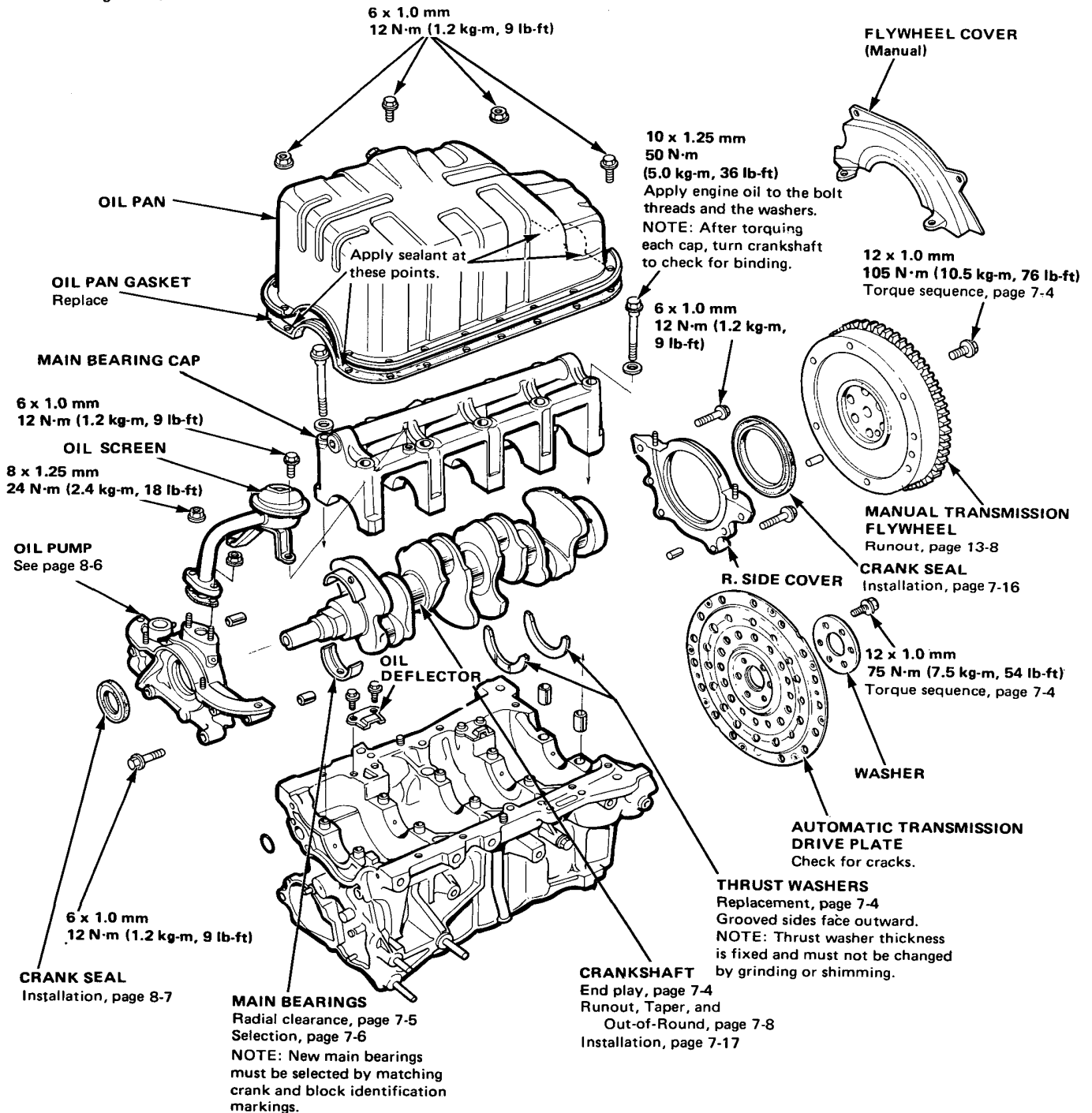



NOTE: New rod bearings must be selected by matching connecting rod and crankshaft identification markings (page 7-6).

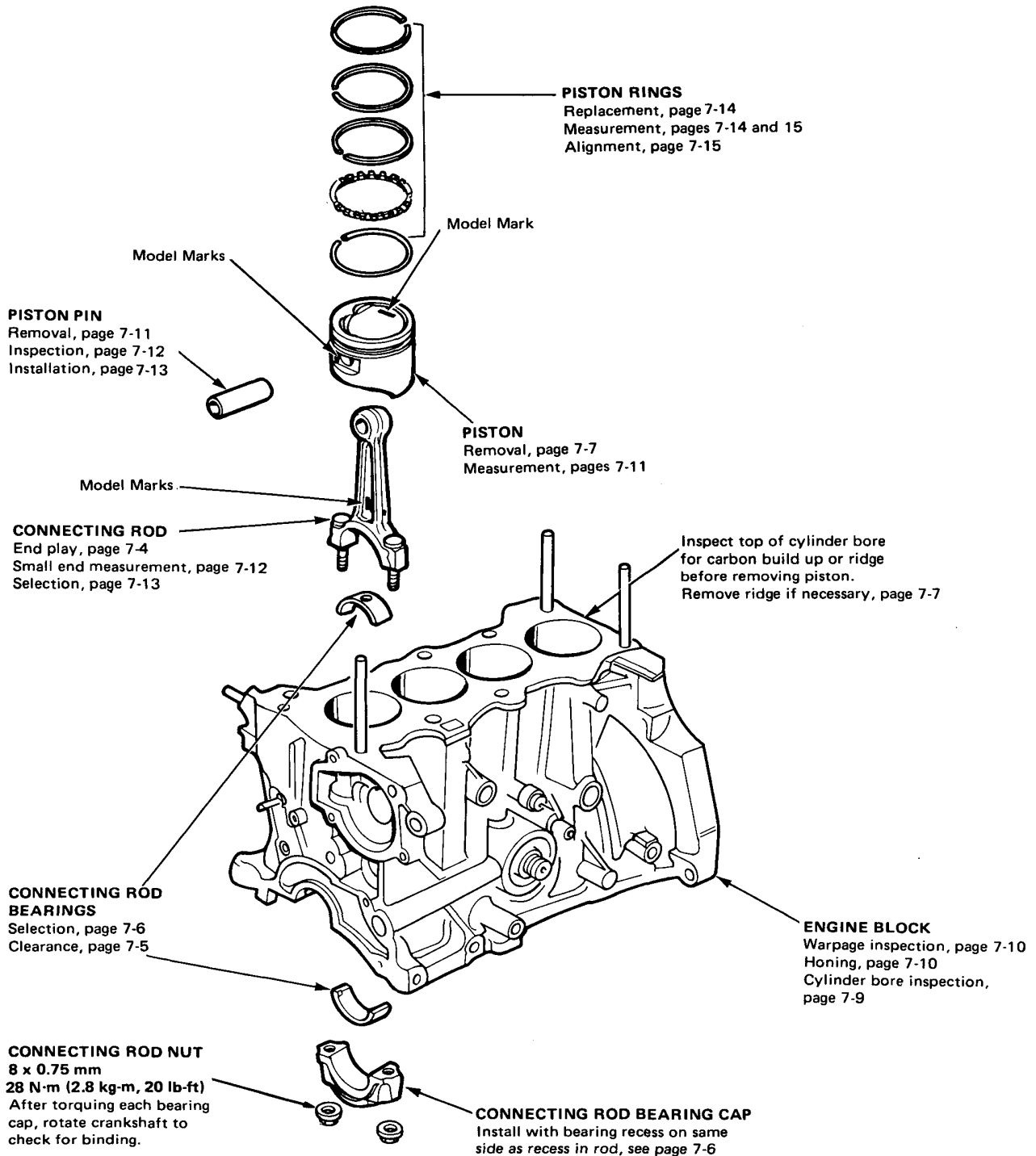

Engine Block

Flywheel Replacement (Manual Transmission)

Remove the six flywheel bolts, then separate the flywheel from the crankshaft flange. After installation, tighten the bolts in the sequence shown.

RING GEAR HOLDER
07924- PE60000

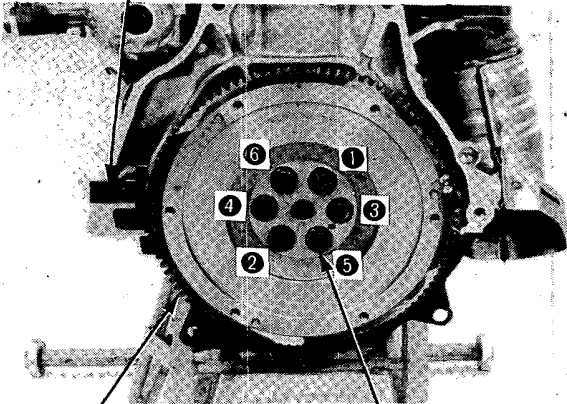

RING GEAR
Inspect ring gear teeth for wear or damage.

12 x 1.0 mm
105 N·m
(10.5 kg-m, 76 lb-ft)

Connecting Rod End Play

Standard (New): 0.15–0.30 mm (0.006–0.012 in.)
Service Limit: 0.40 mm (0.016 in.)

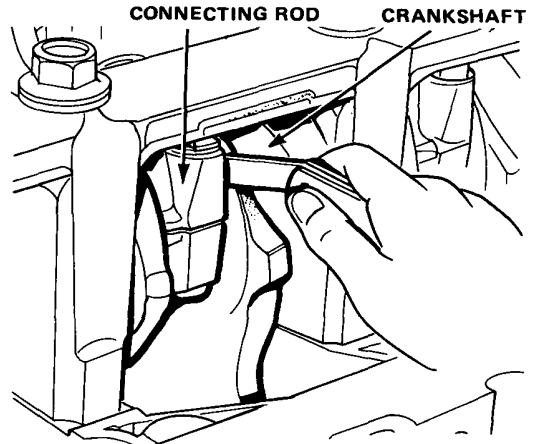

- If out-of-tolerance, install new connecting rod.
- If still out-of-tolerance, replace crankshaft (pages 7-7 and 7-17).

Drive Plate Replacement (Hondamatic Transmission)

Remove the six drive plate bolts, then separate the drive plate from the crankshaft flange. After installation, tighten the bolts in the sequence shown.

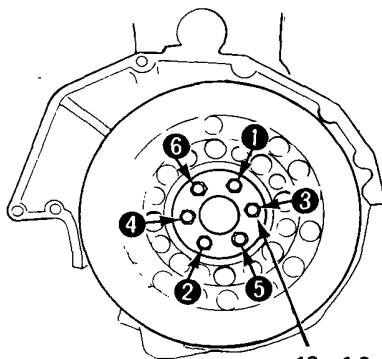

12 x 1.0 mm
75 N·m
(7.5 kg-m, 54 lb-ft)

Crankshaft End Play

Push crank firmly away from dial indicator, and zero dial against end of crank. Then pull crank firmly back toward indicator; dial reading should not exceed service limit.

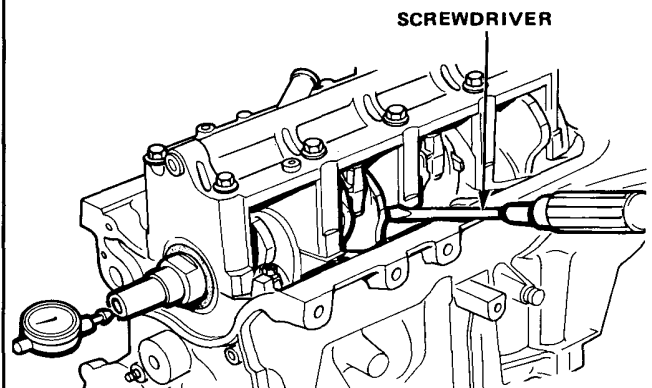

Standard (New): 0.1–0.35 mm (0.004–0.014 in.)
Service Limit: 0.45 mm (0.018 in.)

- If end play is excessive, inspect thrust washers and thrust surface on crankshaft. Replace parts as necessary.

NOTE: Thrust washer thickness is fixed and must not be changed either by grinding or shimming. Thrust washers are installed with grooved sides outward.